

- Previous PEIR & PEIR SIR Assessment Boundary
- Cable route alternatives and modifications**
- New areas of affected land
- Cable installation works (including construction and operational access)
- Construction and operational access

NOTES:

i. where an area is proposed to be used for more than one type of works (other than an access associated with an alternative cable route option), the affected areas are shown with all relevant colours or markings to reflect the multiple work types which may be carried out in the area.

ii. any areas within PEIR & PEIR SIR subject to a change of use are shown shaded on these plans with the revised works description.

DISCLAIMER:
This is an independent set of works plans for the further statutory consultation. The descriptions of the works should be read from the Index Plan of these targeted onshore consultation works plans, rather than the existing draft Development Consent Order text first published in July 2021 for our previous statutory consultation.

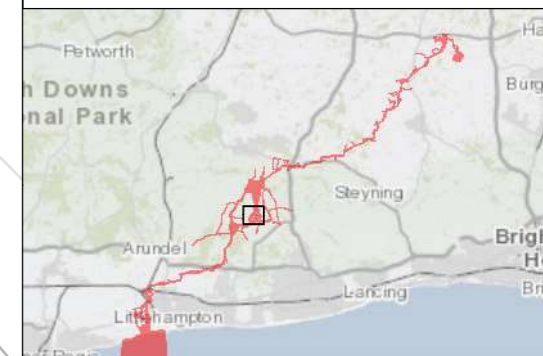

Due to scaling, some narrow areas (i.e. existing tracks) within the red line boundary may appear as a single/solid red line on the map.

Scale when printed at A3 size is 1:5,000

1:5,000
British National Grid Transverse Mercator

Rampion Extension Development Limited



Rampion 2 Offshore Wind Farm
Targeted Onshore Works Plans
Page 4 of 10

System Identifier: 42285-WOOD-PE-ON-PN-MD-0004				Version: 10.0
Company: WOOD	Drawn By: IM	Chk/Aprvd: SN	Drawn Date: 21-Feb-23	Status: FOR USE

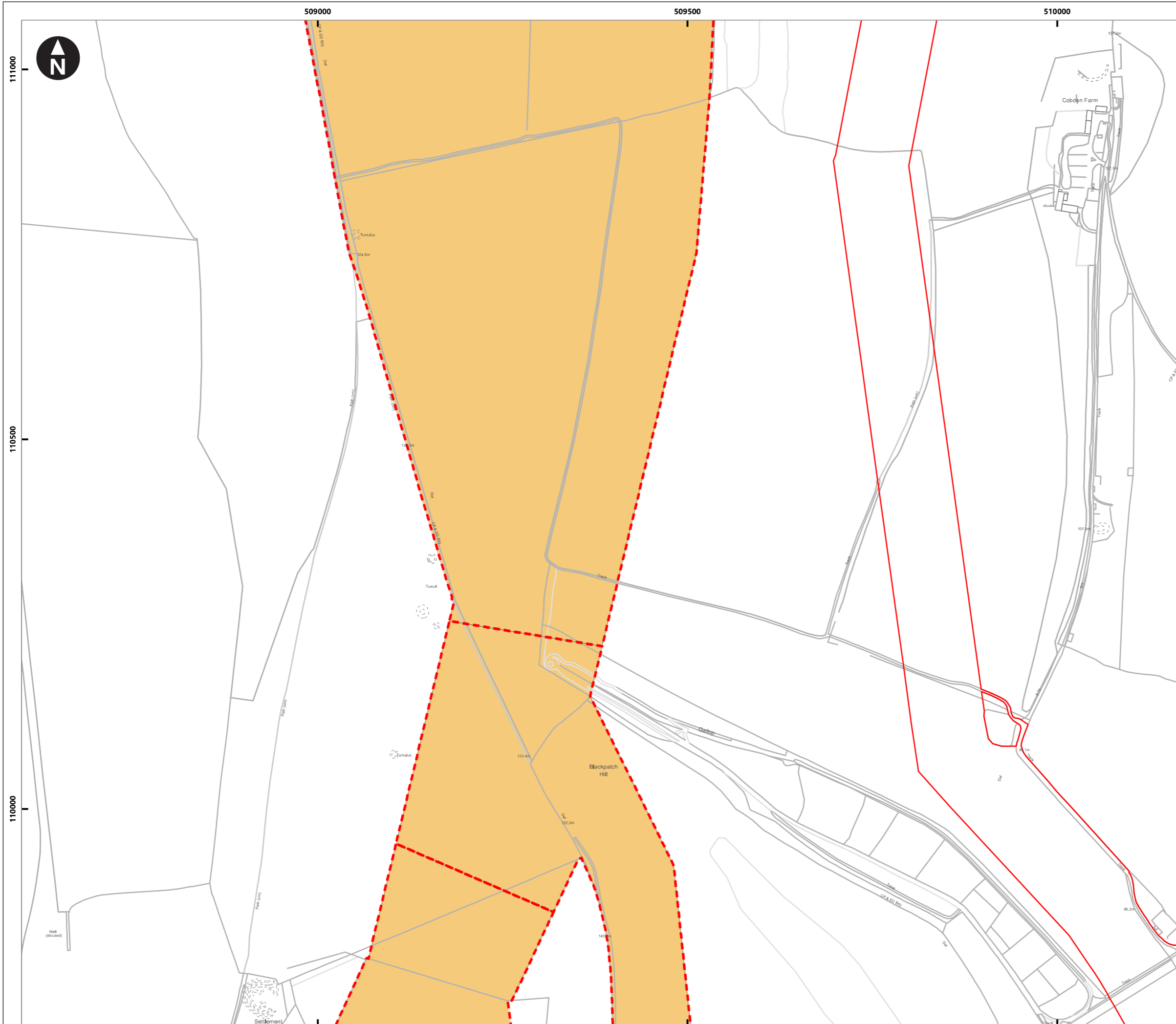

- Previous PEIR & PEIR SIR Assessment Boundary
- Cable route alternatives and modifications**
- New areas of affected land
- Cable installation works (including construction and operational access)

NOTES:

- i. where an area is proposed to be used for more than one type of works (other than an access associated with an alternative cable route option), the affected areas are shown with all relevant colours or markings to reflect the multiple work types which may be carried out in the area.
- ii. any areas within PEIR & PEIR SIR subject to a change of use are shown shaded on these plans with the revised works description.

DISCLAIMER:

This is an independent set of works plans for the further statutory consultation. The descriptions of the works should be read from the Index Plan of these targeted onshore consultation works plans, rather than the existing draft Development Consent Order text first published in July 2021 for our previous statutory consultation.



Due to scaling, some narrow areas (i.e. existing tracks) within the red line boundary may appear as a single/solid red line on the map.

Scale when printed at A3 size is 1:5,000

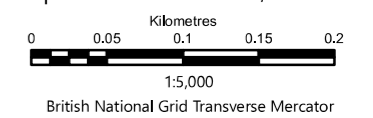

Rampion Extension Development Limited



Rampion 2 Offshore Wind Farm
Targeted Onshore Works Plans
Page 5 of 10

System Identifier: 42285-WOOD-PE-ON-PN-MD-0004				Version: 10.0
Company: WOOD	Drawn By: IM	Chk/Aprvd: SN	Drawn Date: 21-Feb-23	Status: FOR USE

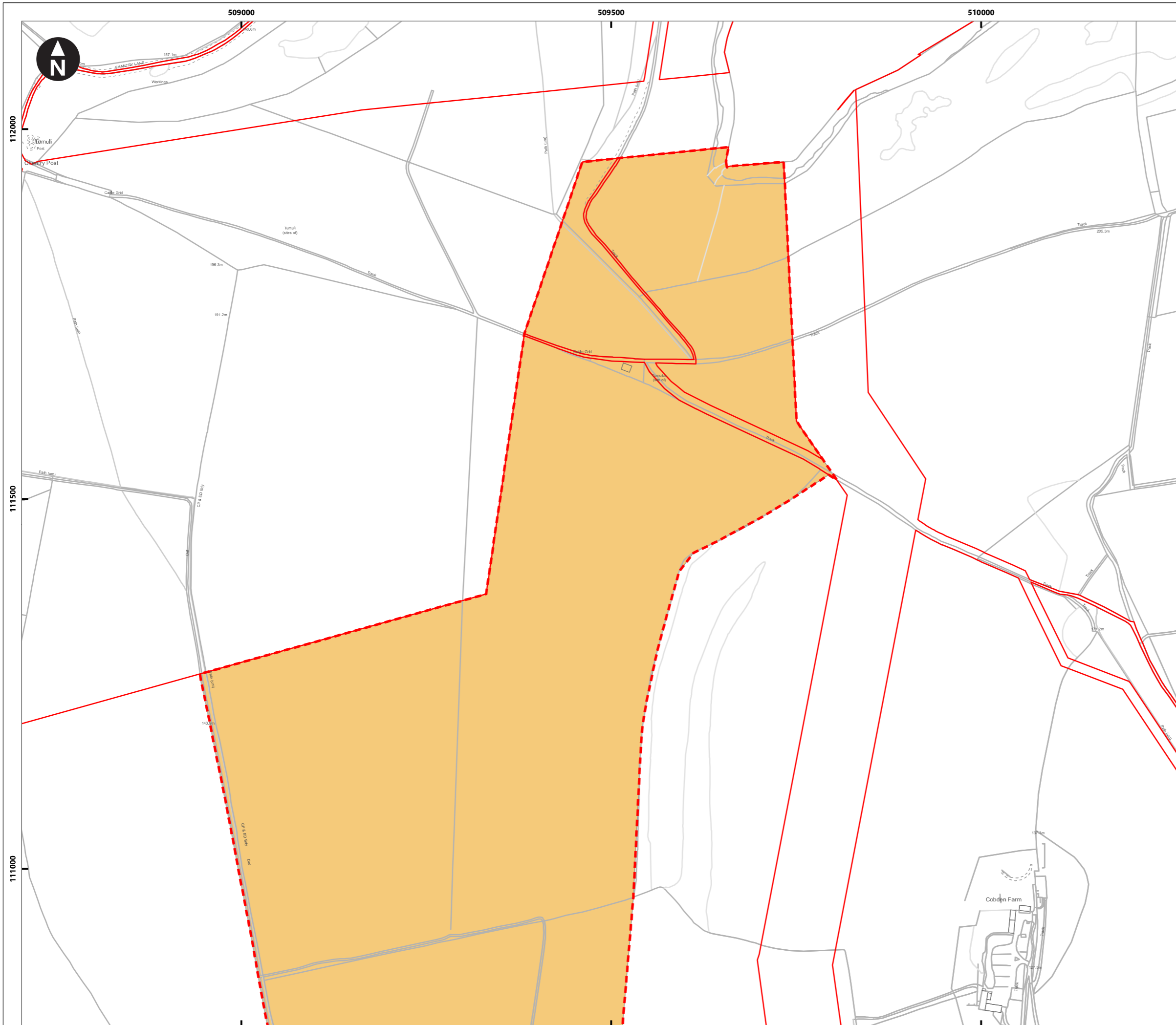

- Previous PEIR & PEIR SIR Assessment Boundary
- Cable route alternatives and modifications**
- New areas of affected land
- Cable installation works (including construction and operational access)

NOTES:

- i. where an area is proposed to be used for more than one type of works (other than an access associated with an alternative cable route option), the affected areas are shown with all relevant colours or markings to reflect the multiple work types which may be carried out in the area.
- ii. any areas within PEIR & PEIR SIR subject to a change of use are shown shaded on these plans with the revised works description.

DISCLAIMER:

This is an independent set of works plans for the further statutory consultation. The descriptions of the works should be read from the Index Plan of these targeted onshore consultation works plans, rather than the existing draft Development Consent Order text first published in July 2021 for our previous statutory consultation.



Due to scaling, some narrow areas (i.e. existing tracks) within the red line boundary may appear as a single/solid red line on the map.

Scale when printed at A3 size is 1:5,000

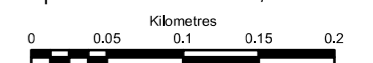

1:5,000
British National Grid Transverse Mercator

Rampion Extension Development Limited



Rampion 2 Offshore Wind Farm
Targeted Onshore Works Plans
Page 6 of 10

System Identifier: 42285-WOOD-PE-ON-PN-MD-0004				Version: 10.0
---	--	--	--	------------------

Company: WOOD	Drawn By: IM	Chk/Aprvd: SN	Drawn Date: 21-Feb-23	Status: FOR USE
------------------	-----------------	------------------	--------------------------	--------------------